

## Pallet Carrier Plate Bolster Insert Plate

### Pallet Carrier Plates

201.96.

For each pallet tooling set, two carrier plates 201.96. are required – one for mounting the top tooling details, the other for the bottom tooling.

The tooling components are doweled into position.

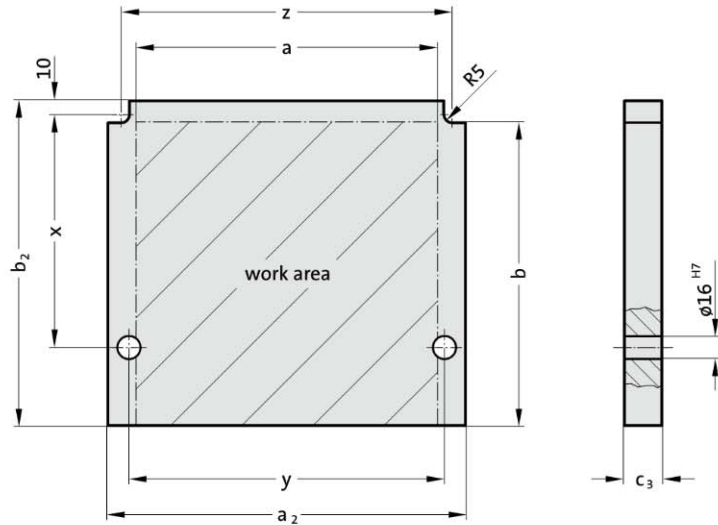

### 201.96. Pallet Carrier Plate

Order No	work area a × b	a <sub>2</sub>	b <sub>2</sub>	c <sub>3</sub>	x	y	z
201.96.1010	100 × 100	150	115	16	50,1	120	130
201.96.2121	210 × 210	250	225	25	160,1	220	230
201.96.3030	300 × 300	350	315	25	250,1	320	330
201.96.3521	350 × 210	400	225	25	160,1	370	380

### Bolster Insert Plates

201.97.

This insert plate has to be added to a tooling pallet set if:

- scrap holes near the centre require additional support
- spring cushions or bottom ejectors have to be employed
- other features of specific die designs require an individual insert plate

Bolster insert plates have a dowel that makes them non-reversible.

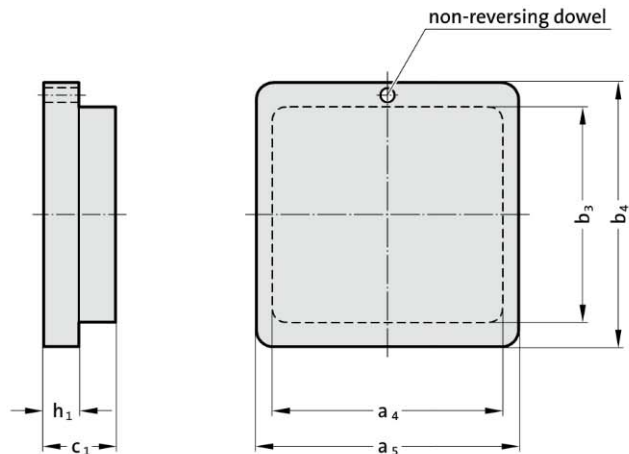

### 201.97. Bolster Insert Plate

Order No	work area a × b	a <sub>4</sub>	a <sub>5</sub>	b <sub>3</sub>	b <sub>4</sub>	c <sub>1</sub>	h <sub>1</sub>
201.97.1010	100 × 100	80	–	60	80	40	20
201.97.2121	210 × 210	160	180	150	180	50	25
201.97.3030	300 × 300	240	270	220	250	63	30
201.97.3521	350 × 210	320	–	120	150	50	25