

Guide pillar with internal thread on top, ~DIN 9825/~ISO 9182-2

202.24.

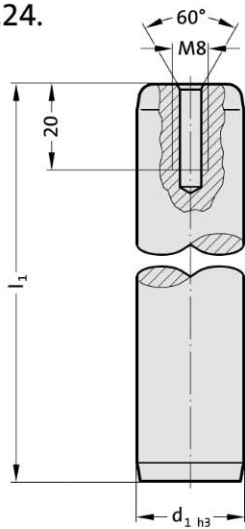

Mounting example

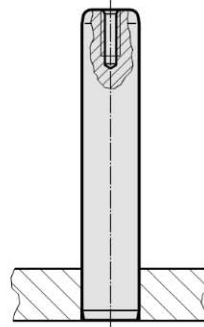

Material:

Steel, (Core strength: $\geq 900 \text{ N/mm}^2$) surface hardened
Surface hardness: 60 + 3 HRC, Hardness penetration $\geq 1,8 \text{ mm}$

Execution:

fine-ground and superfinished
Method of manufacturing entails that centre holes are not concentric with O.D.

Note:

Bearing clearance / Preloading see pairing classification at the beginning of chapter D.
Matching guide combinations, see selection matrix at the beginning of chapter D.
Assembly guide lines / Dimensional requirements and tolerances at the end of chapter D.
Tolerance range:
yellow = .10
green = .20
red = .30



202.24. Guide pillar with internal thread on top, ~DIN 9825/~ISO 9182-2

d_1	15 16	19 20	24 25	30 32	38 40	48 50	60 63	80
l_2	4	4	6	6	6	8	8	8
l_1								
90	●							
100	●	●	●					
112	●	●	●					
125	●	●	●	●				
140	●	●	●	●	●			
160	●	●	●	●	●	●		
180	●	●	●	●	●	●	●	
200	●	●	●	●	●	●	●	
224	●	●	●	●	●	●	●	
250	●	●	●	●	●	●	●	●
280	●	●	●	●	●	●	●	●
315	●	●	●	●	●	●	●	●
355	●	●	●	●	●	●	●	●
400		●	●	●	●	●	●	●
450			●	●	●	●	●	●
500			●	●	●	●	●	●
550				●	●	●	●	●
600				●	●	●	●	●
700				●	●	●	●	●
800				●	●	●	●	●

Ordering Code (example):

Guide pillar with internal thread on top, ~DIN 9825/~ISO 9182-2	=202.24.
Guide diameter d_1	32 mm = 032.
Length l_1	200 mm = 200.
Classification TOL	yellow = 10
Order No	=202.24. 032.200.10