

Guide pillar "ECO-Line", ~DIN 9825/~ISO 9182-2

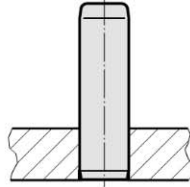

Mounting example



202.29.

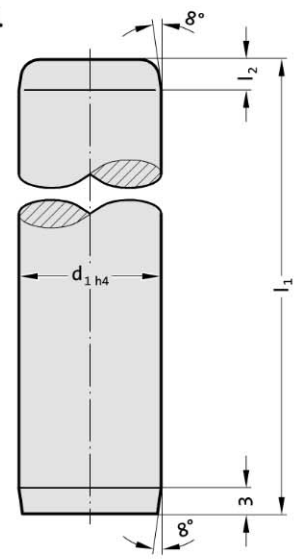

Material:

Steel, surface hardened
Surface hardness: 60 + 3 HRC, Hardness penetration $\geq 1,8$ mm

Execution:

ground
Method of manufacturing entails that centre holes are not concentric with O.D.

Note:

Guide pillars only recommended for use with sliding guides!
Matching guide combinations, see selection matrix at the beginning of chapter D.
Assembly guide lines / Dimensional requirements and tolerances at the end of chapter D.

202.29. Guide pillar "ECO-Line", ~DIN 9825/~ISO 9182-2

d_1	15 16	19 20	24 25	30 32	38 40	48 50	60 63	80
l_2	4	4	6	6	6	8	8	8
l_1								
90	•							
100	•	•	•					
112	•	•	•					
125	•	•	•	•				
140	•	•	•	•				
160	•	•	•	•	•			
180	•	•	•	•	•	•		
200	•	•	•	•	•	•		
224	•	•	•	•	•	•		
250	•	•	•	•	•	•	•	
280	•	•	•	•	•	•	•	•
315	•	•	•	•	•	•	•	•
355	•	•	•	•	•	•	•	•
400		•	•	•	•	•	•	•
450			•	•	•	•	•	•
500			•	•	•	•	•	•
550				•	•	•	•	•
600					•	•	•	•
700					•	•	•	•
800					•	•	•	•

Ordering Code (example):

Guide pillar "ECO-Line", ~DIN 9825/~ISO 9182-2	=	202.29.
Guide diameter d_1	32 mm =	032.
Length l_1	125 mm =	125
Order No	=	202.29. 032.125