

Guide bush, Bronze with solid lubricant

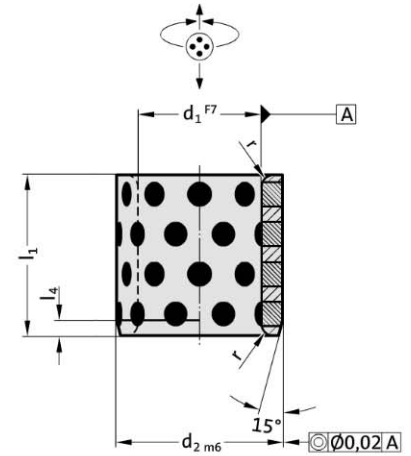

2052.70.



Material:

Bronze with solid lubricant, oilless lubricating

Note:

Bushes can be used with radial or axial motion.

Matching guide combinations, see selection matrix at the beginning of chapter D.

Assembly guide lines / Dimensional requirements and tolerances at the end of chapter D.

Attention:

Note that press fitment reduces inside bush diameter.

2052.70. Guide bush, Bronze with solid lubricant

	8	10	10	12	13	14	15	16	18	19	20	20	20	24	25	25	25	28	30	30	30	30	31.5	32	35	35	38	40	40					
d ₁	8	10	10	12	13	14	15	16	18	19	20	20	20	24	25	25	25	28	30	30	30	30	31.5	32	35	35	38	40	40					
d ₂	12	14	15	18	19	20	21	22	24	25	26	28	30	32	32	33	35	38	38	40	42	42	40	42	44	45	48	50	55					
r	0.5	0.5	0.5	0.5	0.5	0.5	0.75	0.75	0.75	0.75	0.75	0.75	0.75	0.75	0.75	0.75	0.75	0.75	0.75	0.75	0.75	0.75	0.75	0.75	0.75	1.5	1.5	1.5						
l ₄	2	2	2	2	2	2	2	2	2	2	4	4	4	4	4	4	4	4	4	4	4	4	4	4	4	4	4	4	4					
l ₁	8	10	10	12	13	14	15	16	18	19	20	20	20	24	25	25	25	28	30	30	30	30	31.5	32	35	35	38	40	40					
8	•	•																																
10	•	•	•	•	•	•	•	•																										
12	•	•		•	•	•	•	•																										
15	•	•		•	•	•	•	•	•	•																								
16				•	•	•	•	•	•	•																								
20		•		•	•	•	•	•	•	•																								
25				•	•	•	•	•	•	•																								
30				•	•	•	•	•	•	•																								
35																																		
37																																		
40																																		
47																																		
50																																		
60																																		
70																																		
77																																		
80																																		

Ordering Code (example):

Guide bush, Bronze with solid lubricant	=	2052.70.
Guide diameter d ₁	40 mm =	040.
External diameter d ₂	55 mm =	055.
Installation length l ₁	25 mm =	025
Order No	=	2052.70.040.055.025