

Ejector pin, nitrided, similar to DIN 1530 Shape D

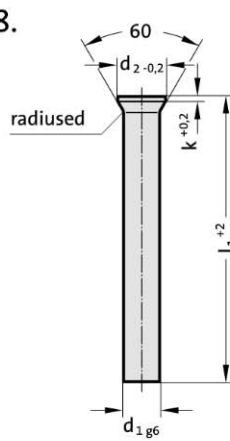

239.8.



Material:

NWA
 Order No **239.8.**
 Hardness:
 Shaft* ≥ 950 HV 0,3
 Head 45 ± 5 HRC
 Tensile Strength (core) > 1400 N/mm²

Description of FIBRO materials for tool and die components see at the beginning of Chapter E.

Execution:

Shank nitrided and precision ground.
 Head hot upset-forged.

Note:

*Owing to thinness of nitrided skin, hardness testing on shank restricted to Vickers only.
 Test load = 3 N max.

239.8. Ejector pin, nitrided, similar to DIN 1530 Shape D

d ₁	d ₂	k	l ₁	l ₁	l ₁	l ₁	l ₁	l ₁
			100	125	160	200	250	315
3	4.5	0.5	●	●	●	●	●	●
4	5.5	0.5	●	●	●	●	●	●
5	6.5	0.5	●	●	●	●	●	●
6	8	0.5	●	●	●	●	●	●
8	10	1	●	●	●	●	●	●
10	12	1	●	●	●	●	●	●
12	14	1	●	●	●	●	●	●
14	16	1.5	●	●	●	●	●	●
16	18	1.5	●	●	●	●	●	●

Ordering Code (example):

Ejector pin, nitrided, similar to DIN 1530 Shape D	=	239.8.
Shank diameter d ₁	8 mm =	0800.
Length l ₁	100 mm =	100
Order No	=	239.8. 0800.100