



Material:
Bronze with solid lubricant, oilless lubricating

Note:
Screws not included.

Fixing:
Use socket cap screws DIN EN ISO 4762 M12.

2960.70.

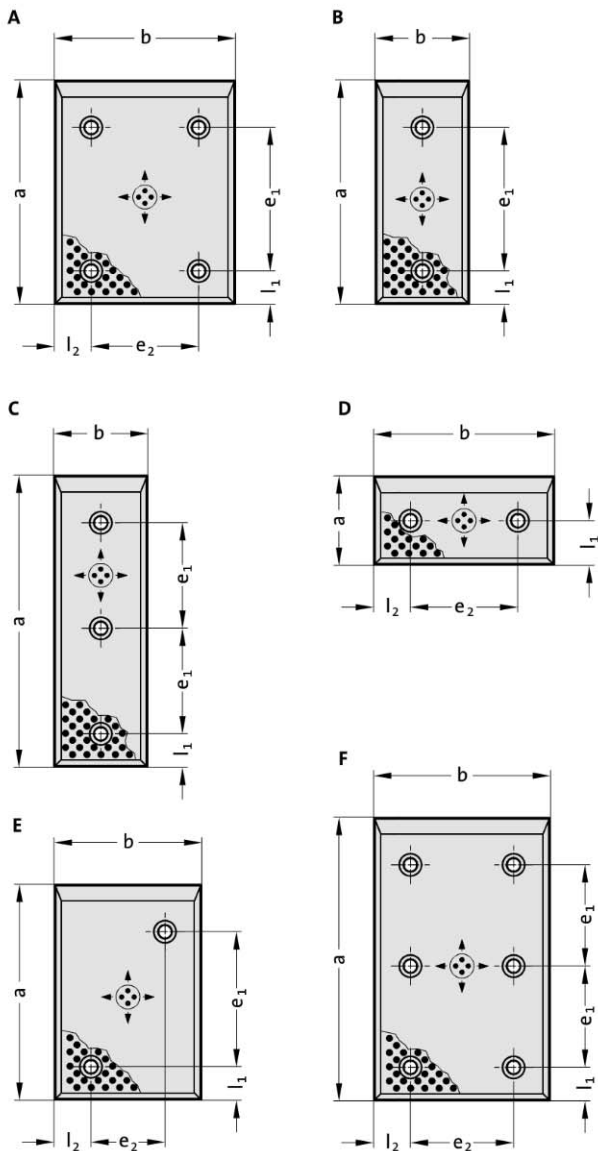

2960.70.

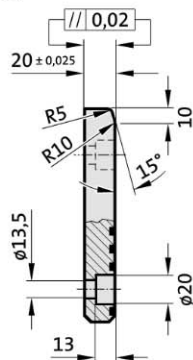



Sliding pad, Bronze with solid lubricant, ISO 9183-1

2960.70. Sliding pad, Bronze with solid lubricant, ISO 9183-1

Order No	Shape	b	a	l ₁	e ₁	l ₂	e ₂
2960.70.050.080	B	50	80	20	35	25	-
2960.70.050.100	B	50	100	20	55	25	-
2960.70.050.125	B	50	125	20	80	25	-
2960.70.050.160	B	50	160	20	115	25	-
2960.70.050.200	B	50	200	20	155	25	-
2960.70.050.250	C	50	250	20	100	25	-
2960.70.080.050	D	80	50	25	-	20	40
2960.70.080.080	E	80	80	20	35	20	40
2960.70.080.100	E	80	100	20	55	20	40
2960.70.080.125	E	80	125	20	80	20	40
2960.70.080.160	A	80	160	20	115	20	40
2960.70.080.200	A	80	200	20	155	20	40
2960.70.080.250	F	80	250	20	100	20	40
2960.70.080.315	F	80	315	20	132	20	40
2960.70.100.050	D	100	50	25	-	20	60
2960.70.100.080	E	100	80	20	35	20	60
2960.70.100.100	E	100	100	20	55	20	60
2960.70.100.125	A	100	125	20	80	20	60
2960.70.100.160	A	100	160	20	115	20	60
2960.70.100.200	A	100	200	20	155	20	60
2960.70.100.250	F	100	250	20	100	20	60
2960.70.100.315	F	100	315	20	132	20	60
2960.70.125.050	D	125	50	25	-	20	85
2960.70.125.080	E	125	80	20	35	20	85
2960.70.125.100	A	125	100	20	55	20	85
2960.70.125.125	A	125	125	20	80	20	85
2960.70.125.160	A	125	160	20	115	20	85
2960.70.125.200	A	125	200	20	155	20	85
2960.70.125.250	F	125	250	20	100	20	85
2960.70.125.315	F	125	315	20	132	20	85
2960.70.160.050	D	160	50	25	-	20	120
2960.70.160.080	A	160	80	20	35	20	120
2960.70.160.100	A	160	100	20	55	20	120
2960.70.160.125	A	160	125	20	80	20	120
2960.70.160.160	A	160	160	20	115	20	120
2960.70.160.200	A	160	200	20	155	20	120
2960.70.160.250	F	160	250	20	100	20	120
2960.70.160.315	F	160	315	20	132	20	120