

Guide bar with three sliding surfaces, Bronze with solid lubricant

2962.76.

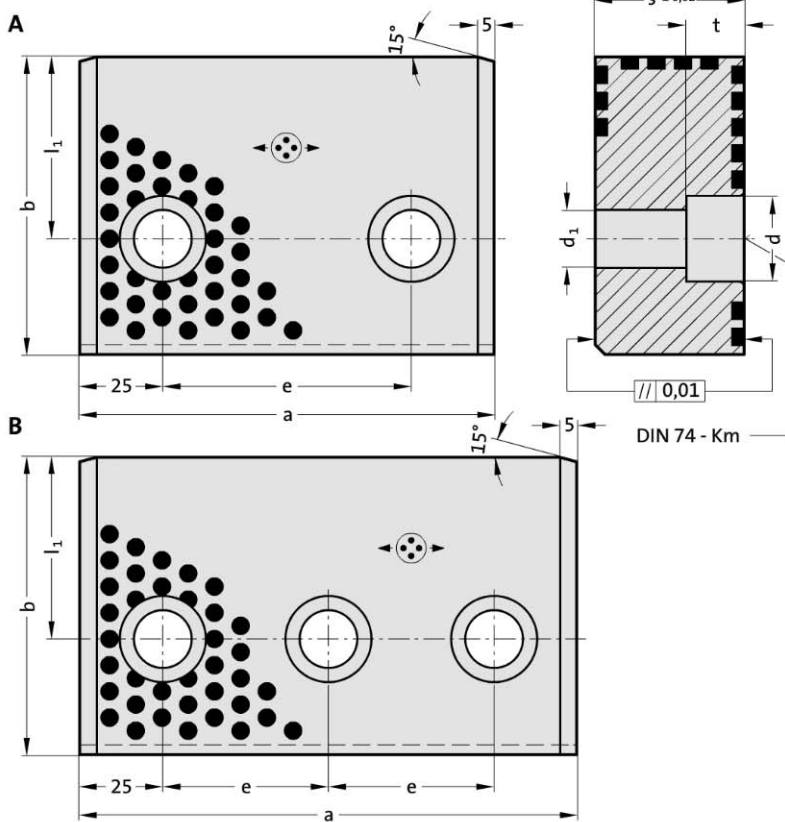

Material:

Bronze with solid lubricant, oilless lubricating

Note:

Screws not included.

Fixing:

Use socket cap screws DIN EN ISO 4762.



2962.76. Guide bar with three sliding surfaces, Bronze with solid lubricant

Order No	Shape	a	b	s	e	l ₁	d	d ₁	t	Number of screw holes
2962.76.070.032.0125	A	125	70	32	75	40	20	13.5	13	2
2962.76.070.032.0150	A	150	70	32	100	40	20	13.5	13	2
2962.76.070.032.0200	B	200	70	32	75	40	20	13.5	13	3
2962.76.090.045.0125	A	125	90	45	75	55	26	17.5	17.5	2
2962.76.090.045.0150	B	150	90	45	50	55	26	17.5	17.5	3
2962.76.090.045.0200	B	200	90	45	75	55	26	17.5	17.5	3