

# CU4 11800

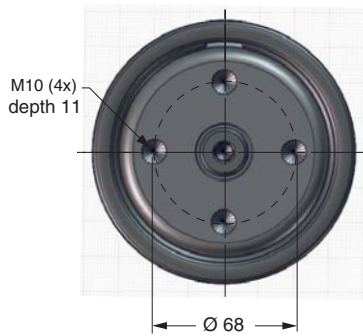
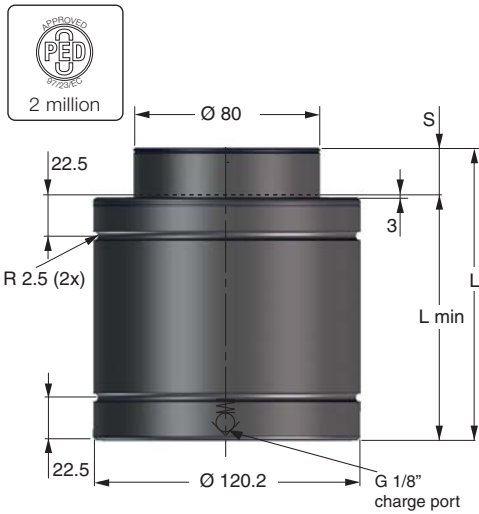

The CU4 gas spring is a very compact Bore Sealed gas spring with impressive force in a compact body. The maximum frequency for the spring is 100 strokes/minute.

Springs with stroke lengths over 25 mm should always be attached to the tool, using a flange or the tapped holes in the bottom of the spring. We also recommend fixing of shorter stroke springs for optimal service life.

As an option, the CU4 spring can be delivered with a Side Port plate (SP) for applications where a sideport is needed (e.g., for use in hose systems).

Order No.	S stroke	Force in N at 150 bar/+20°C		Force in lbf at 150 bar/+20°C		L ±0.25	L min.	Gas vol. (l)	Weight (kg)
		Initial	End force**	Initial	End force**				
CU4 11800-010	10	118,000	150,000	26,530	33,700	100	90	0.33	4.95
CU4 11800-016	16		153,000		34,400	126	110	0.50	5.55
CU4 11800-025	25		160,000		36,000	155	130	0.68	6.17
CU4 11800-032	32*		165,000		37,100	187	155	0.88	6.90
CU4 11800-040	40*		160,000		36,000	220	180	1.00	7.65
CU4 11800-050	50*		161,000		36,200	260	210	1.35	8.55
CU4 11800-050	65*		163,000		36,600	320	255	1.90	9.56

\* Should always be attached to the tool using the tapped holes in the bottom or a flange  
 \*\* at full stroke

## Basic Information

For general information see "About gas springs", 2.1  
 Pressure medium..... Nitrogen  
 Max. charging pressure..... 150 bar (at 20°C)  
 Min. charging pressure..... 25 bar (at 20°C)  
 Operating temperature ..... 0 to +80°C  
 Force increase by temperature ..... ±0.3%/°C  
 Recommended max strokes/min .... ~80 to 100 (at 20°C)  
 Max piston rod velocity ..... 0.8 m/s

Rod surface..... Nitrided  
 Tube surface ..... Nitrided  
 Repair kit CU4 11800 ..... 3024840  
 Repair kit CU 11800 ..... 2014493-1180  
 Available until 12.31.2015

## Mounting Possibilities

