

CU4 7500

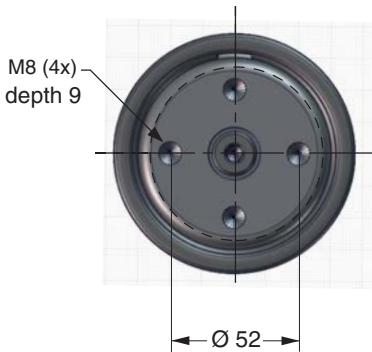
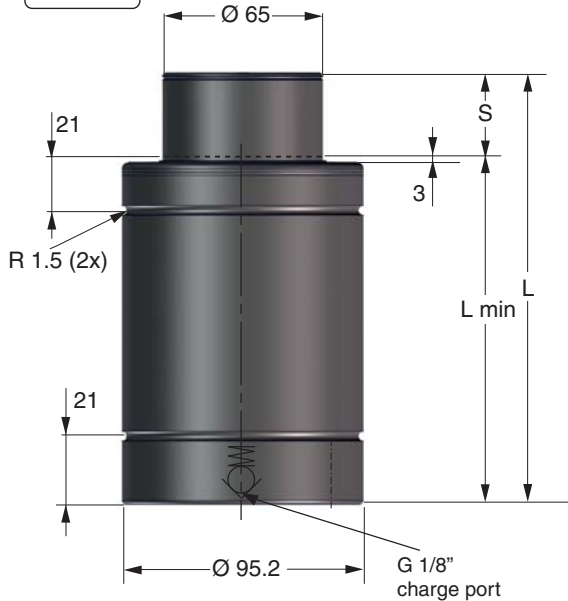

The CU4 gas spring is a very compact Bore Sealed gas spring with impressive force in a compact body. The maximum frequency for the spring is 100 strokes/minute.

Springs with stroke lengths over 25 mm should always be attached to the tool, using a flange or the tapped holes in the bottom of the spring. We also recommend fixing of shorter stroke springs for optimal service life.

As an option, the CU4 spring can be delivered with a Side Port plate (SP) for applications where a sideport is needed (e.g., for use in hose systems).

Order No.	S stroke	Force in N at 150 bar/+20°C		Force in lbf at 150 bar/+20°C		L ±0.25	L min.	Gas vol. (l)	Weight (kg)
		Initial	End force**	Initial	End force**				
CU4 7500-010	10		98500		22,143	90	80	0.18	2.86
CU4 7500-016	16		100000		22,480	116	100	0.30	3.22
CU4 7500-025	25		104000		23,380	145	120	0.41	3.61
CU4 7500-032	32*	75,000	102000	16,860	22,930	182	150	0.57	4.14
CU4 7500-040	40*		104000		23,380	210	170	0.68	4.52
CU4 7500-050	50*		103000		23,155	255	205	0.87	5.15
CU4 7500-065	65*		111000		24,953	279	214	1.00	5.23

* Should always be attached to the tool using the tapped holes in the bottom or a flange
 ** at full stroke

Basic Information

For general information see "About gas springs", 2.1
 Pressure medium..... Nitrogen
 Max. charging pressure..... 150 bar (at 20°C)
 Min. charging pressure..... 25 bar (at 20°C)
 Operating temperature 0 to +80°C
 Force increase by temperature ±0.3%/°C
 Recommended max strokes/min ~80 to 100 (at 20° C)
 Max piston rod velocity 0.8 m/s

Rod surface..... Nitrided
 Tube surface Nitrided
 Repair kit CU4 7500 3024839
 Repair kit CU 7500 2014493-0750
 Available until 12.31.2015

Mounting Possibilities

