

SLME 170

Order No.	S Stroke	Force in N at 180 bar/ + 20°C		L ±0.25	L min	Gas volume (l)	Weight (kg)
		Initial	End force*				
SLME 170-025	25	1700	2800	127	102	0.006	0.81
SLME 170-038	38			153	115	0.009	0.88
SLME 170-050	50			177	127	0.012	0.94
SLME 170-063	63			203	140	0.015	1.01
SLME 170-080	80			240	160	0.019	1.10
SLME 170-100	100			280	180	0.024	1.21
SLME 170-125	125			330	205	0.030	1.35

*At full stroke

Max. attachment capacity per lifter* Metric	
Ram velocity (m/s)	Attachment mass (kg)
0.15	80
0.30	20
0.40	11
0.50	7
0.60	5

*Determine ram velocity and reference the recommended attachment mass per lifter. For increased capacity, install external positive stops to prevent lifter damage.

Mounting examples

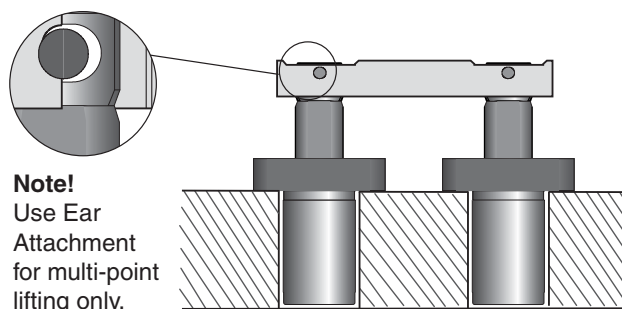

SLMT 170

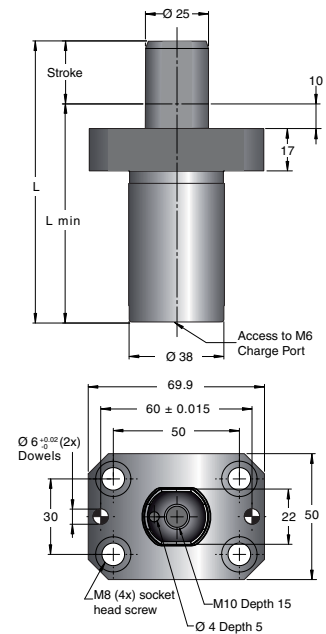

Order No.	S Stroke	Force in N at 180 bar/ + 20°C		L ±0.25	L min	Gas volume (l)	Weight (kg)
		Initial	End force*				
SLMT 170-025	25	1700	2800	112	87	0.006	0.79
SLMT 170-038	38			138	100	0.009	0.86
SLMT 170-050	50			162	112	0.012	0.92
SLMT 170-063	63			188	125	0.015	0.99
SLMT 170-080	80			225	145	0.019	1.09
SLMT 170-100	100			265	165	0.024	1.19
SLMT 170-125	125			315	190	0.030	1.33

*At full stroke

Basic information

Initial force range..... 240-1700 N
 Pressure medium..... Nitrogen
 Charging pressure range..... 25-180 bar
 Operating temperature range..... 0-80° C
 Force increase by temperature..... ±0.3% / °C
 Recommended max. strokes/min..... 40-100 (at 20°C)
 Max. piston rod velocity..... 0.6 m/s
 Max. utilised stroke..... 100%
 Internal gas spring..... X 170

