

X 1500

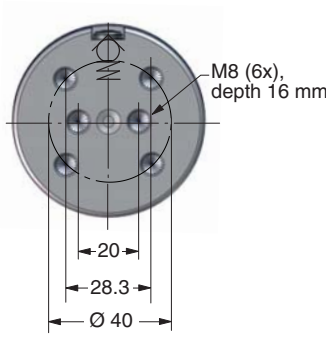
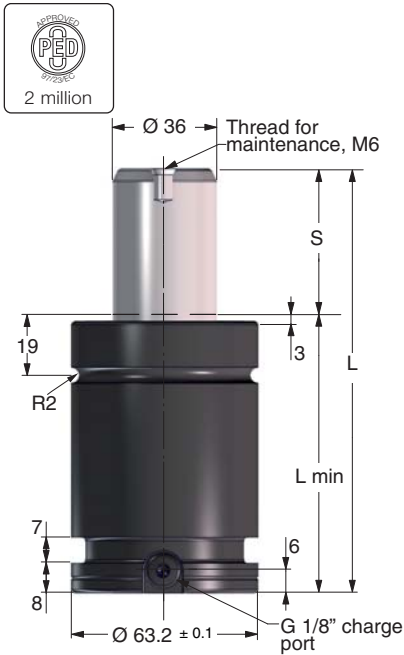

The Power Line Series includes our shortest and most powerful Piston Rod Sealed gas springs, offering impressive force in a very compact format.

These gas springs are available with forces from 1,700 N up to 200,000 N and stroke lengths between 7 and 125 mm.

There is a side port for gas charging that can also be used to connect to a hose system.

An upper C-groove, lower U-groove together with two M8 threaded holes allow various mounting possibilities using our standard mounts.

Order No.	S stroke	Force in N at 150 bar/+20°C		Force in lbf at 150 bar/+20°C		L ±0.25	L min.	Gas vol. (l)	Weight (kg)
		Initial	End force*	Initial	End force*				
X 1500-013	** 13	15,000	24,000	3,375	5,395	70	57	0.05	0.89
X 1500-016	16		24,100		5,420	76	60	0.06	0.93
X 1500-019	19		24,200		5,440	82	63	0.07	0.96
X 1500-025	** 25		24,300		5,365	94	69	0.08	1.03
X 1500-032	32		23,800		5,355	108	76	0.11	1.08
X 1500-038	** 38		23,900		5,375	120	82	0.12	1.15
X 1500-050	** 50		24,000		5,395	144	94	0.15	1.28
X 1500-063	** 63		24,100		5,420	170	107	0.19	1.43
X 1500-075	75		24,200		5,440	194	119	0.22	1.57
X 1500-080	** 80		24,200		5,440	204	124	0.24	1.63
X 1500-100	** 100		24,300		5,465	244	144	0.29	1.86
X 1500-125	** 125		24,300		5,465	294	169	0.36	2.15

* = at full stroke

** Recommended stroke length for optimal delivery

Basic Information

- For general information see "About gas springs", 2.1
- Pressure medium Nitrogen
- Max. charging pressure 150 bar (at 20°C)
- Min. charging pressure 25 bar (at 20°C)
- Operating temperature 0 to +80°C
- Force increase by temperature ±0.3%/°C
- Recommended max strokes/min ... ~ 50 to 100 (at 20°C)
- Max piston rod velocity 1.6 m/s
- Rod surface Nitrided
- Tube surface Black oxide
- Repair kit 3020434

Mounting Possibilities

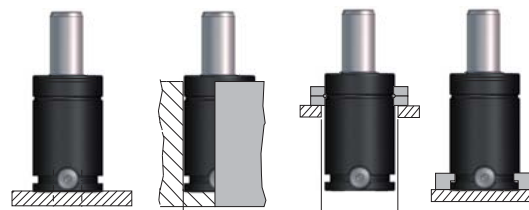

Base mount B, MPX
 Drop-in
 Top mount FCX, FCSX
 Foot mount KX, FFX

Note! For dimensions on mounting possibility KX-1500 refer to Chapter 3.

X 1500 Mounts

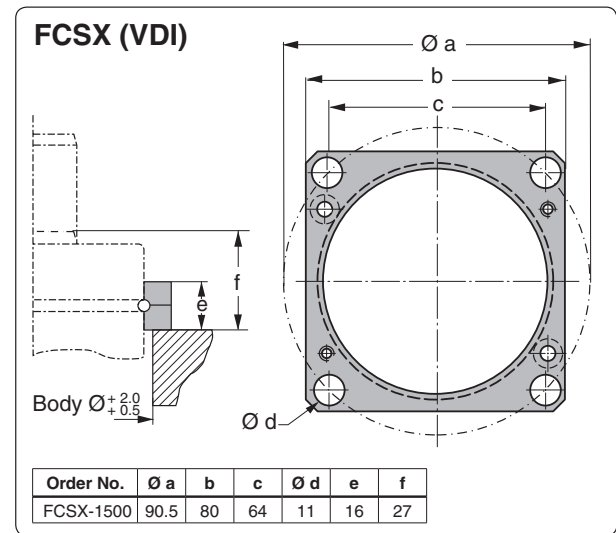
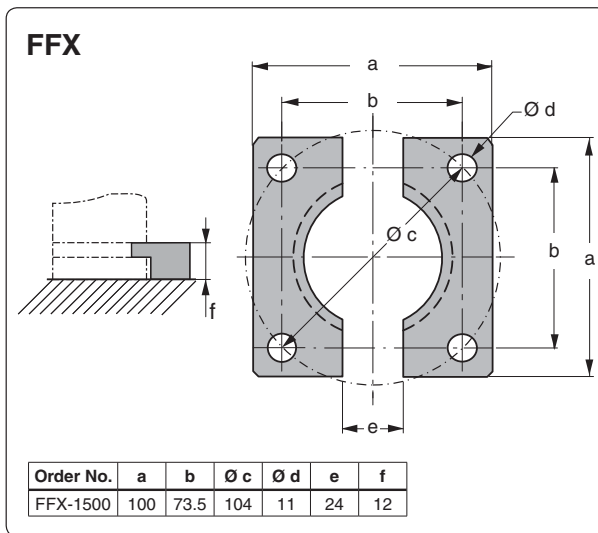
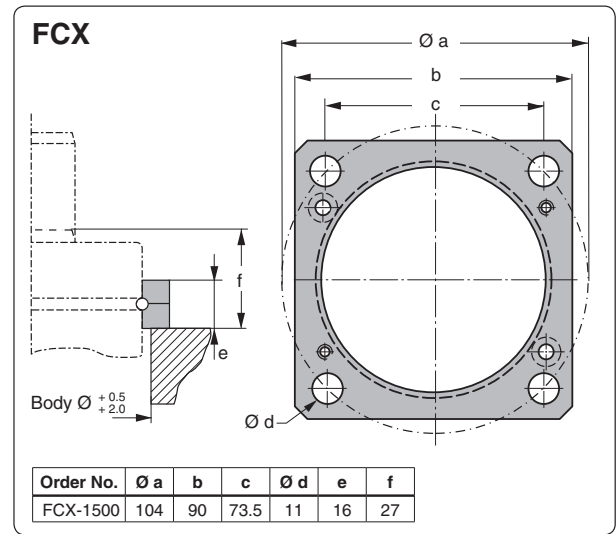
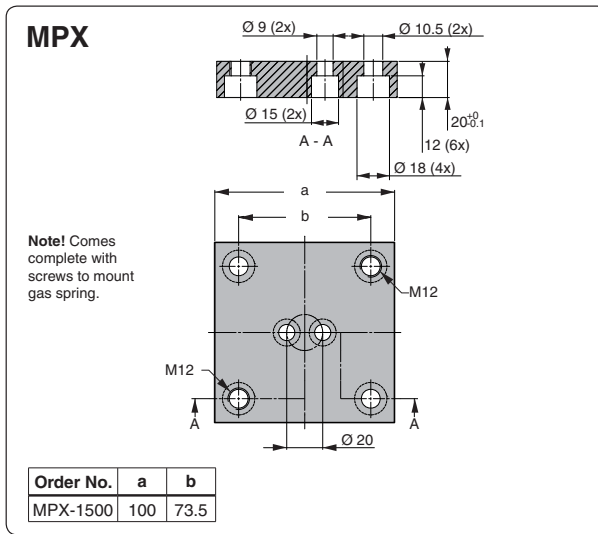

Note! For dimensions on mounting possibility KX-1500 refer to Chapter 3.